

PATCH CORDS AND TEST LEADS

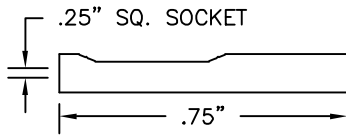

.025" (.635mm) SQUARE SOCKET
SHOWN WITH HEAT SHRINK

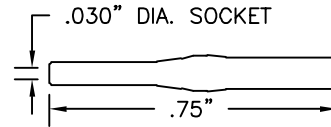

.030" (.762mm) DIAMETER SOCKET
SHOWN WITH HEAT SHRINK

THESE MODELS AVAILABLE IN THE FOLLOWING TEST LEAD COMBINATIONS

Standard wire for the following leads is 22 AWG PVC.
All patch cords come standard with heatshrink over the sockets.

Standard lengths include:

| | | | |
|-----|------|-----|-------|
| 6" | 15cm | 30" | 75cm |
| 12" | 30cm | 36" | 90cm |
| 18" | 45cm | 48" | 120cm |
| 24" | 60cm | 60" | 150cm |

| COLOR CHART | |
|-------------|--------|
| Black | Green |
| Brown | Blue |
| Red | Violet |
| Orange | Gray |
| Yellow | White |

SETS & CUSTOM COLOR

Standard Sets:
R/B = 1 red, 1 black
S = 1 each of 10 colors
S(color) = 10 of one color

Additional lead lengths, wire types, and custom leads are available upon request.

Test leads available in the above colors.

.025" (.635mm) TO .025" (.635mm) SQUARE SOCKET

.030" (.762mm) TO .030" (.762mm) DIAMETER SOCKET



.025" (.635mm) SQUARE SOCKET: Gold-plated beryllium copper spring. Heat shrink insulation. Crimp assembly. See Part No. 9205.

.030" (.762mm) DIAMETER SOCKET: Gold-plated nickel copper body with stainless steel hood. Heat shrink insulation. Crimp assembly.

| Socket Model | Part Number | Wire Type | Socket Material |
|----------------|-----------------------|--------------------|--------------------|
| .025" (.635mm) | 9110-(length)-(color) | 22 AWG 65 x 40 PVC | Gold-Plated Socket |
| .025" (.635mm) | 9120-(length)-(color) | 28 AWG 19 x 40 PVC | Gold-Plated Socket |
| .025" (.635mm) | 9175-(length)-(color) | 22 AWG 65 x 40 PVC | Tin-Plated Socket |
| .030" (.762mm) | 9860-(length)-(color) | 22 AWG 65 x 40 PVC | Gold-Plated Socket |

SOCKET TO LEAD ONLY

| Socket Model | Part Number | Wire Type |
|--------------------|-----------------------|------------|
| .025" (.635mm) | 9121-(length)-(color) | 22 AWG PVC |
| .025" (.635mm) | 9122-(length)-(color) | 28 AWG PVC |
| .025" (tin-plated) | 9887-(length)-(color) | 22 AWG PVC |
| .030" (.762mm) | 9844-(length)-(color) | 22 AWG PVC |

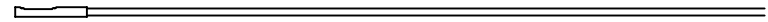

SOCKET: See selected socket model.

SOCKET TO STANDARD BANANA PLUG

| Socket Model | Part Number |
|----------------|-----------------------|
| .025" (.635mm) | 9166-(length)-(color) |
| .030" (.762mm) | 9861-(length)-(color) |

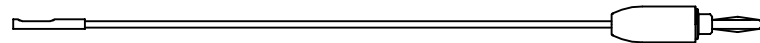

SOCKET: See selected model style.
STANDARD BANANA PLUG: See Part No. 9202

SOCKET TO STACKING STANDARD BANANA PLUG

| Socket Model | Part Number |
|----------------|-----------------------|
| .025" (.635mm) | 9169-(length)-(color) |
| .030" (.762mm) | 9867-(length)-(color) |



SOCKET: See selected socket model.
STACKING STANDARD BANANA PLUG: See Part No. 9203.

SOCKET TO METER BANANA PLUG

| Socket Model | Part Number |
|----------------|-----------------------|
| .025" (.635mm) | 9170-(length)-(color) |
| .030" (.762mm) | 9870-(length)-(color) |



SOCKET: See selected socket model.
METER BANANA PLUG: See Part No. 9206.

PATCH CORDS AND TEST LEADS

SOCKET TO MINIATURE BANANA PLUG

| Socket Model | Part Number |
|----------------|-------------------------------|
| .025" (.635mm) | 9168 -(length)-(color) |
| .030" (.762mm) | 9869 -(length)-(color) |

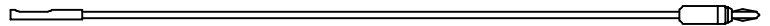

SOCKET: See selected socket model.
MINIATURE BANANA PLUG: See Part No. 9213.

SOCKET TO .080" (2.03mm) PIN PLUG

| Socket Model | Part Number |
|----------------|-------------------------------|
| .025" (.635mm) | 9167 -(length)-(color) |
| .030" (.762mm) | 9862 -(length)-(color) |

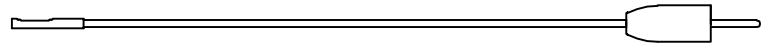

SOCKET: See selected socket model.
STANDARD PIN PLUG: See Part No. 9201.

SOCKET TO .080" (2.03mm) STACKING PIN PLUG

| Socket Model | Part Number |
|----------------|-------------------------------|
| .025" (.635mm) | 9171 -(length)-(color) |
| .030" (.762mm) | 9866 -(length)-(color) |



SOCKET: See selected socket model.
STACKING .080" (2.03mm) PIN PLUG: See Part No. 9204.

SOCKET TO STANDARD ALLIGATOR CLIP

| Socket Model | Part Number |
|----------------|-------------------------------|
| .025" (.635mm) | 9172 -(length)-(color) |
| .030" (.762mm) | 9868 -(length)-(color) |

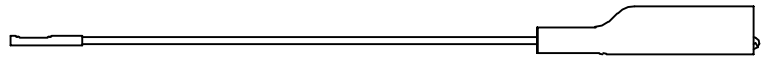

SOCKET: See selected socket model.
STANDARD ALLIGATOR CLIP: See Part No. 9274.

SOCKET TO MINIATURE ALLIGATOR CLIP

| Socket Model | Part Number |
|----------------|-------------------------------|
| .025" (.635mm) | 9173 -(length)-(color) |
| .030" (.762mm) | 9864 -(length)-(color) |

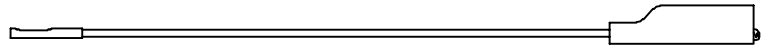

SOCKET: See selected socket model.
MINIATURE ALLIGATOR CLIP: See Part No. 9275.

SOCKET TO STANDARD BANANA SOCKET

| Socket Model | Part Number |
|----------------|-------------------------------|
| .025" (.635mm) | 9163 -(length)-(color) |
| .030" (.762mm) | 9863 -(length)-(color) |

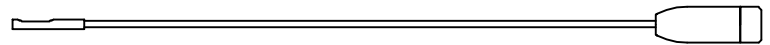

SOCKET: See selected socket model.
STANDARD BANANA SOCKET: See Part No. 9210.

SOCKET TO FEMALE 6-32 THREAD

| Socket Model | Part Number |
|----------------|-------------------------------|
| .025" (.635mm) | 9174 -(length)-(color) |
| .030" (.762mm) | 9924 -(length)-(color) |

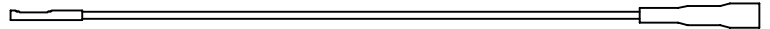

SOCKET: See selected socket model.
FEMALE 6-32 THREAD SOCKET: See Part No. 9212.

SOCKET TO SHROUDED RIGHT ANGLE BANANA PLUG

| Socket Model | Part Number |
|----------------|-------------------------------|
| .025" (.635mm) | 9808 -(length)-(color) |
| .030" (.762mm) | 9872 -(length)-(color) |



SOCKET: See selected socket model.
SHROUDED RIGHT ANGLE BANANA PLUG: See Part No. 9302.

.025" SQUARE SOCKET TO .025" SQUARE PIN

| Part Number |
|-------------------------------|
| 9149 -(length)-(color) |



SOCKET: See .025" square socket.
.025" SQUARE PIN PLUG: See Part No. 9265-HS.

.025" (.635mm) SQUARE SOCKET TO .030" (.762mm) DIAMETER SOCKET

| Part Number |
|-------------------------------|
| 9850 -(length)-(color) |

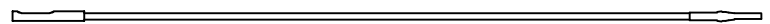

SOCKETS: See page 52 for socket descriptions.